

Nylon Lock Nut TR-PL/TR-PLC

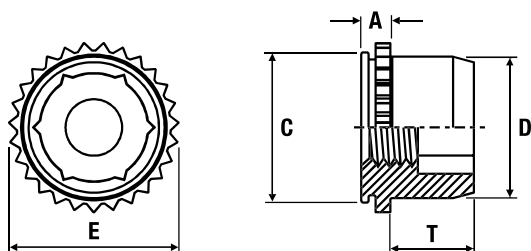

Metric Dimensions

Zinc Plated Steel: TR-PL | Stainless Steel: TR-PLC

Thread	M3	M4	M5
A max.	1.53	1.53	1.53
Sheet thickness	1.0 - 1.78	1.0 - 1.78	1.0 - 1.78
Recommended hole size +0.08	6.0	7.5	8.0
C max.	5.98	7.48	7.98
D max.	5.52	7.01	7.52
E max.	7.01	8.54	9.0
T max.	3.56	4.2	4.45
Min. distance to edge of sheet	4.32	5.59	6.35
Max. hole in attached parts	3.5	4.5	5.5

Metric Performance Data

Thread	M3	M4	M5
Test sheet material	Steel		
Installation (kN)	13.34	13.34	13.34
Push-out (N)	1156	1290	1557
Torque-out (Nm)	2.25	6.77	7.90

TR-PL - Recommended for use in sheet hardness: HRB 70 or less
 TR-PLC - Recommended for use in sheet hardness: HRB 70 or less

