

# Locking Floating Nut TR-LAS/TR-LAC

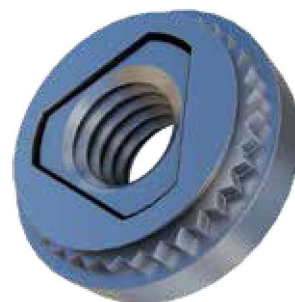
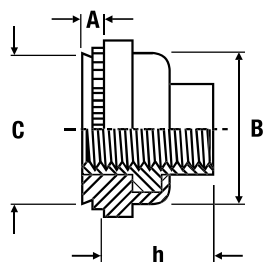
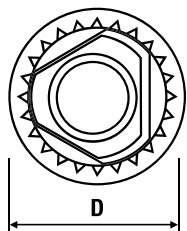

## Metric Dimensions

Zinc Plated Steel: TR-LAS | Stainless Steel: TR-LAC

Thread	M3		M4		M5		M6
	1	2	1	2	1	2	2
Shank code	1	2	1	2	1	2	2
A max.	0.97	1.38	0.97	1.38	0.97	1.38	1.38
Min. sheet thickness	0.97	1.38	0.97	1.38	0.97	1.38	1.38
Recommended hole size +0.08	7.37		9.35		10.31		13.08
B max.	7.35		9.33		10.29		13.06
C max.	7.37		9.28		10.29		12.96
D ±0.4	9.14		11.18		11.94		15.24
h max.	4.83		5.34		6.86		7.88
Min. distance to edge of sheet	7.62		8.64		9.14		10.67

## Metric Performance Data

Thread	M3		M4		M5		M6
	1	2	1	2	1	2	2
Shank code	1	2	1	2	1	2	2
Test sheet material	Steel						
Installation (kN)	13.3	13.3	13.3	13.3	15.6	15.6	22.2
Push-out (N)	1340	1340	1340	1784	1789	2009	2226
Torque-out (Nm)	9.7	17.0	17.1	22.8	16.9	22.9	36.9

TR-LAS - Recommended for use in sheet hardness: HRB 70 or less

TR-LAC - Recommended for use in sheet hardness: HRB 70 or less

