

Non-Locking Floating Nut TR-AS/TR-AC

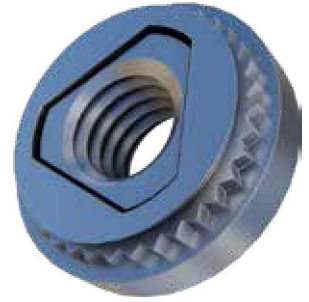
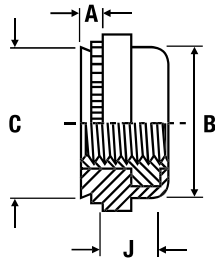
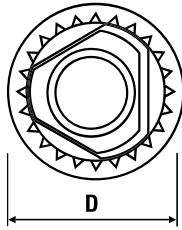

Metric Dimensions

Zinc Plated Steel: TR-AS | Stainless Steel: TR-AC

Thread	M3		M4		M5		M6
Shank code	1	2	1	2	1	2	2
A max.	0.97	1.38	0.97	1.38	0.97	1.38	1.38
Min. sheet thickness	0.97	1.38	0.97	1.38	0.97	1.38	1.38
Recommended hole size +0.08	7.37		9.35		10.31		13.08
B max.	7.35		9.33		10.29		13.06
C max.	7.37		9.28		10.29		12.96
D ±0.4	9.14		11.18		11.94		15.24
J max.	3.31		3.31		4.32		5.34
Min. distance to edge of sheet	7.62		8.64		9.14		10.67

Metric Performance Data

Thread	M3		M4		M5		M6
Shank code	1	2	1	2	1	2	2
Test sheet material	Steel						
Installation (kN)	13.3	13.3	13.3	13.3	15.6	15.6	22.2
Push-out (N)	1340	1340	1340	1784	1789	2009	2226
Torque-out (Nm)	9.7	17.0	17.0	22.8	17.0	22.9	36.9

TR-AS - Recommended for use in sheet hardness: HRB 70 or less

TR-AC - Recommended for use in sheet hardness: HRB 70 or less

