

Flush Nut TR-F/TR-F4

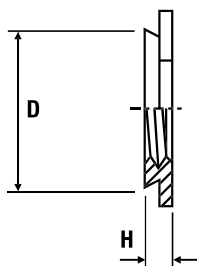
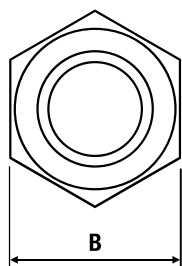

Metric Dimensions

Stainless Steel: TR-F | 400 Series Stainless Steel TR-F4

Thread	M2, M2.5		M3		M3alt		M3.5		M4		M5		M6		
Shank code	1	2	1	2	1	2	1	2	1	2	1	2	3	4	5
D max.	4.35		4.35		5.35		5.35		7.35		7.90		8.72		
B nom.	4.8		4.8		6.4		6.4		7.9		8.7		9.5		
H max.	1.53	2.3	1.53	2.3	1.53	2.3	1.53	2.3	1.53	2.3	1.53	2.3	3.05	3.84	4.63
Sheet thickness	1.53 - 2.3	2.32 min.	1.53 - 2.3	2.32 min.	1.53 - 2.3	2.32 min.	1.53 - 2.3	2.32 min.	1.53 - 2.3	2.32 min.	1.53 - 2.3	2.32 min.	3.18 - 3.94	3.96 - 4.72	4.75 min.
Recommended hole size +0.08	4.37		4.37		5.4		5.4		7.37		7.92		8.74		
Min. distance to edge of sheet	6.0		6.0		6.5		6.5		7.2		8.0		8.8		

Metric Performance Data (TR-F)

Thread	M2, M2.5		M3		M3alt		M3.5		M4		M5		M6		
Shank code	1	2	1	2	1	2	1	2	1	2	1	2	3	4	5
Test sheet material	Steel														
Test sheet thickness	1.5	2.3	1.5	2.3	1.5	2.3	1.5	2.3	1.5	2.3	1.5	2.3	3.1	3.9	4.75
Installation (kN)	13.5		13.5		13.5		13.5		18.0		22.0		26.5		
Push-out (N)	900		900		1100		1100		1060		1060		3700		

Metric Performance Data (TR-F4)

Thread	M2, M2.5		M3		M4		M5		M6		
Shank code	1	2	1	2	1	2	1	2	3	4	5
Test sheet material	300 series stainless steel										
Test sheet thickness	1.5	2.3	1.5	2.3	1.5	2.3	1.5	2.3	3.1	3.9	4.75
Installation (kN)	32		32		40		40		65		
Push-out (N)	1200		1200		2000		2000		4500		

TR-F - Recommended for use in sheet hardness: HRB 70 or less
 TR-F4 - Recommended for use in sheet hardness: HRB 80 or less

