

Broaching Stud TR-KFH

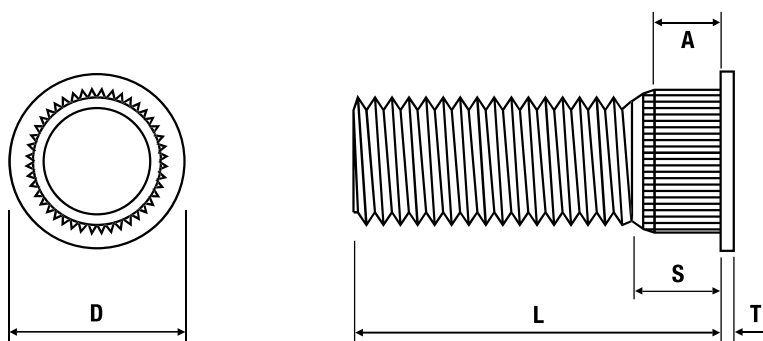

Metric Dimensions

Electro-Tin Plated Phosphor Bronze: TR-KFH

Thread	M2.5	M3	M4	M5
D ± 0.25	4.10	4.58	5.74	6.6
S max.	2.3	2.3	2.3	2.3
A max.	1.65	1.65	1.65	1.65
T ± 0.13	0.51	0.51	0.51	0.51
Min. sheet thickness	1.53	1.53	1.53	1.53
Recommended hole size +0.08	2.6	3.0	4.2	5.0
Min. distance to edge of sheet	3.3	3.8	5.1	5.3

Length (L) ± 0.4	6	8	10	12	15

TR-KFH - Recommended for use in sheet hardness: HRB 55 or less

